

Permit # 14-003

Date 5/12/14

TOWN OF EATON
PO BOX 66 CEDAR ST
MORRISVILLE NY 13408
MADISON COUNTY, NEW YORK

Shoulder Excavation, Driving/Boring under pavement, Open cut
Application is hereby made by the undersigned for permission to excavate within the Town of Eaton Highway right of way.

Road name Wendover Road
Tax Map Reference # 137.00
Description of work Install 10" HDPE gas main across
Wendover Road just west of the State Route 46 intersection.

Owner Name Village of Hamilton
Address 3 Broad Street Hamilton, NY 13346

Contractor Name Adhan Construction
Address _____

It is understood that the following conditions constitute a part of this permit and are agreed to by undersigned.

- 1.) The applicant shall hold the Town of Eaton harmless from any and all damages and claims arising from the work.
- 2.) The permit holder shall maintain and protect traffic by conducting their construction operations so that the traveling public is subject to a minimum of delay and free from hazard. Adequately lighted or reflectorized warning signs and barricades, including red flags, shall be furnished and erected to guide and protect traffic until the work is completed. In addition advanced warning signs shall be set 500 feet on each side of the work zone. The applicant or contractor shall provide flagman when necessary. Any additional traffic control or protection required by the Town of Eaton shall be provided at the applicant's expense.

No construction materials or equipment shall be left in the public right of way after working hours, nor shall any construction equipment or materials be placed in any manor or location that will obstruct highway-warning signs.

All open trenches in the highway shall be barricaded. There shall be conspicuously displayed bright red flags not less than 30x30 attached to such barricades and illuminated at night. If in the sole judgment of the representative of the Highway Superintendent, flagmen are necessary, they shall be employed by the contractor and on duty at all times during the progress of the work so as to direct traffic and maintain a safe work area.

Soft shoulder signs of adequate size, not less than 30" square shall be erected and maintained on all backfill trenches within the shoulder area until the backfill is thoroughly settled. These signs shall be located at the beginning of each area of work at intersections at a distance not greater than 1000 feet apart. During winter conditions highway shoulders shall be maintained free of obstructions, which would interfere with snow removal and ice control.

The permit holder shall keep the roadway free of foreign objects such as rocks, timber and other items that may fall from transporting vehicles. Spillage of materials carried by or dropped from under the undercarriage of any carrying vehicle resulting from the contractors travel way shall be removed immediately. The permit holder shall keep roadway free of such spillages, both within and outside the work area.

- 3.) The work shall progress with out delay and shall not start until necessary materials and equipment are available. The Highway Superintendent shall be notified at least five days before starting work. If work has begun without notification, this permit shall be revoked.
- 4.) No shoulder cuts shall be closer than 7 feet from pavement edge for boring operations. Installation of pipelines parallel to road shall not be closer than 5 feet from edge of shoulder, unless approved in writing by the Highway Superintendent.

- 5.) Backfill for excavation within shoulder area;
- Whenever the trench excavation is within 5 feet of the pavement or paved gutter and/or within areas normally used by traffic, bank run gravel backfill with 2 inch maximum particle size shall be placed in 12-inch layers and each layer thoroughly compacted; the top 24 inches shall consist of crusher run gravel and compacted.
 - Where the depth of the trench excavation is greater than the distance from the edge of the pavement to the edge of the trench sheeting may be required and left in place if so ordered by a representative of the highway department. The backfill of the sheeted area shall proceed as stated above.
- 6.) Backfill for excavation within areas outside of pavement and shoulder:
- The backfill in trenches beyond the shoulder and pavement areas but within the roadway area shall be maintained level with the original surface at all times.
 - All surplus material must be removed.
- 7.) The highway shall be restored to its original condition. The highway must be kept clean at all times with no mud, stone or other materials left on the pavement. Dust control device, such as calcium chloride, will be required.
- 8.) Any temporary power line crossings shall provide minimum of 18 feet clearance above the crown of the road.
- 9.) Tree trimmings, Tree removal shall be shown on sketch to be attached to the application.
- 10.) Warning and regulatory signs on town roads shall not be disturbed, damaged or moved by any person, contractor, or corporation granted this permit. When work allowed under this permit requires warning or regulatory signs must moved or taken down, the contractor or person performing work under this permit shall notify the town highway department by telephone between 7:00 am and 3:30 pm Monday through Friday except April 1 through October 1 Monday through Thursday. The town highway department will take down, move and later erect any signs that may interfere with the work. The cost of taking down, moving and later erecting any warning or regulatory signs and the cost of repairing or replacing any such signs damaged in the work area, shall be charged to the person, contractor, corporation acquiring this permit.
- 11.) Completion of work: The permit holder shall be required to restore shoulders and ditches and clean up the highway as work progresses. All driveways shall be restored with material in kind and to their original conditions. The permit holder shall replace any existing driveway pipes damaged by construction with new material. Corrugated metal pipe or smooth wall HDPE pipe may be used provided there is at minimum of 12 inches of cover. Permit holder shall check with the highway department for correct size.
- 12.) A bond in the amount of not less than \$1000.00 with the amount to be determined in the discretion of the Highway Superintendent is required to guarantee road and shoulder repair. The bond shall be good for 1 year following completion of project.
- 13.) Whenever highway construction or heavy maintenance plans remodel the existing highway system, utility companies or other permit holders shall conform at their own expense.
- 14.) A 24 hour notice is required for inspection by the town highway department, two inspections are required for driving/boring and four inspections are required for an open road cut. Each cut or bore will need its own permit and inspections, even if on the same road.
- Should the Highway Superintendent identify problems with the applicant's/ contractor's work during construction or within one year thereafter, the applicant shall repair or address such problems within three days of receiving written or verbal notice to remedy any problem or defect to the Highway superintendent's satisfaction.
- 15.) A certificate naming the Town of Eaton as additional insured confirming that workers compensation insurance and liability insurance with coverage limits of not less than \$1 million per occurrence are in effect during the period of construction will accompany the permit application.
- 16.) Area to be excavated shall be checked for flood zone requirements.
- Acceptance of the requested permit, subjects permit holder to restrictions regulations obligations stated on this application.

Signed  Address Village of Hamilton

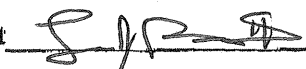
Date 5/12/14 Highway Superintendent 

Permit expires two months from date above.

Permit Fee \$250.00
Inspection Fees \$50.00/ inspection

* CONDITION OF APPROVAL REQUIRING ASBUILT TO BE PROVIDED TO TOWN HIGHWAY SUPERINTENDENT AT COMPLETION OF CONSTRUCTION.

WORK AREA DIAGRAM

Please draw simple drawing of excavation area

(SEE ATTACHED PERMIT PLANS)

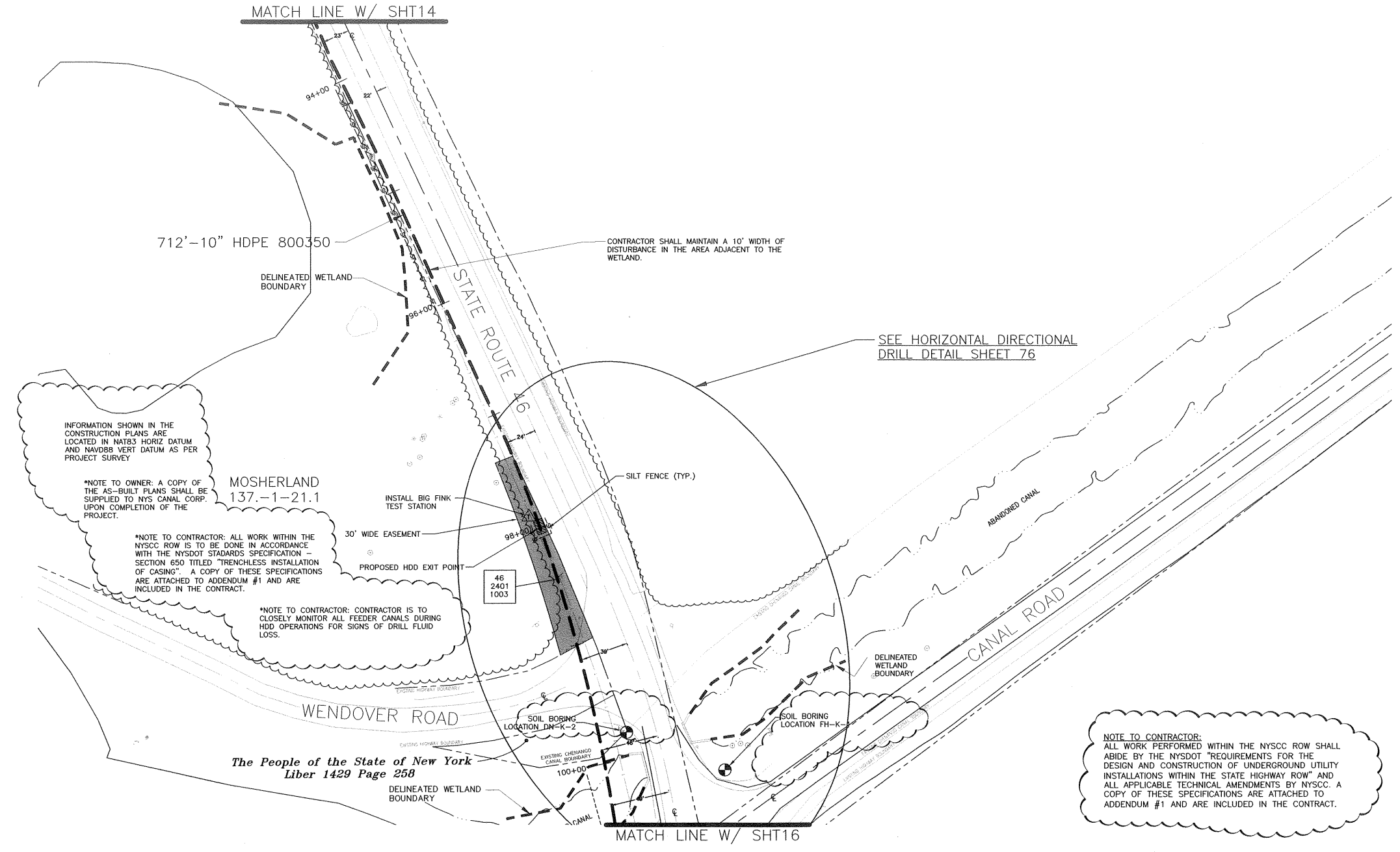

INFORMATION SHOWN IN THE CONSTRUCTION PLANS ARE LOCATED IN NAT83 HORIZ DATUM AND NAVD88 VERT DATUM AS PER PROJECT SURVEY

*NOTE TO OWNER: A COPY OF THE AS-BUILT PLANS SHALL BE SUPPLIED TO NYS CANAL CORP. UPON COMPLETION OF THE PROJECT.

*NOTE TO CONTRACTOR: ALL WORK WITHIN THE NYSCC ROW IS TO BE DONE IN ACCORDANCE WITH THE NYSDOT STANDARDS SPECIFICATION - SECTION 650 TITLED "TRENCHLESS INSTALLATION OF CASING". A COPY OF THESE SPECIFICATIONS ARE ATTACHED TO ADDENDUM #1 AND ARE INCLUDED IN THE CONTRACT.

*NOTE TO CONTRACTOR: CONTRACTOR IS TO CLOSELY MONITOR ALL FEEDER CANALS DURING HDD OPERATIONS FOR SIGNS OF DRILL FLUID LOSS.

The People of the State of New York
Liber 1429 Page 258

CONTRACTOR SHALL MAINTAIN A 10' WIDTH OF DISTURBANCE IN THE AREA ADJACENT TO THE WETLAND.

SEE HORIZONTAL DIRECTIONAL DRILL DETAIL SHEET 76

NOTE TO CONTRACTOR:
ALL WORK PERFORMED WITHIN THE NYSCC ROW SHALL ABIDE BY THE NYSDOT "REQUIREMENTS FOR THE DESIGN AND CONSTRUCTION OF UNDERGROUND UTILITY INSTALLATIONS WITHIN THE STATE HIGHWAY ROW" AND ALL APPLICABLE TECHNICAL AMENDMENTS BY NYSCC. A COPY OF THESE SPECIFICATIONS ARE ATTACHED TO ADDENDUM #1 AND ARE INCLUDED IN THE CONTRACT.

NOTE TO OWNER: THIS MAP WAS CREATED FROM PREVIOUS CONSTRUCTION PLANS PREPARED BY INTERGRITY ENGINEERING FOR THE HAMILTON PIPELINE PROJECT. DDS COMPANIES IS NOT RESPONSIBLE FOR THE INFORMATION INCLUDED IN THESE DRAWINGS OTHER THAN THE REVISIONS ADDRESSING THE AGENCY COMMENTS FOR FINAL PERMITTING. NO FIELD VERIFICATION HAS BEEN DONE TO VERIFY EXISTING FEATURES, ELEVATIONS OR PLAN LOCATIONS REPRESENTED ON THESE PLANS AS PREPARED AND DESIGNED BY THE OWNERS ENGINEER OF RECORD FOR THE CREATION OF THE PROJECT CONTRACT DOCUMENTS.

NOTE TO CONTRACTOR: THIS MAP WAS CREATED FROM AVAILABLE RECORD MAPS, TAX MAPS, AERIAL OVERLAYS, AND WHERE POSSIBLE A FIELD EDIT WAS PERFORMED. NO ACTUAL FIELD SURVEY WAS PERFORMED AND THEREFORE DDS COMPANIES CANNOT ASSURE ITS ACCURACY. EXISTING UTILITY LOCATIONS AND TOPOGRAPHIC INFORMATION ARE APPROXIMATE AND SHALL BE VERIFIED IN THE FIELD BY THE CONTRACTOR PRIOR TO COMMENCING CONSTRUCTION OR APPLYING IT FOR ANY PURPOSE.

HAMILTON PIPELINE
Village of Hamilton
County of Madison
State of New York

REV.#	Description	Date	By

DESIGN	APPROVAL	DATE

PROJECT NO.
HAM 22-14-H001

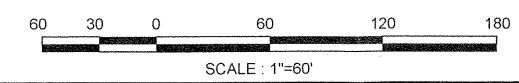

ADDENDUM #1

DDS 45 HENDRIX ROAD
W. HENRIETTA, NY 14586
PHONE (585) 359-7540
FAX (585) 359-7547

DATE: MARCH 2014
DESIGNED BY: C. KARELUS
CHECKED BY:
APPROVED BY:
AS-BUILT DATE:

SHEET NO.
SH15

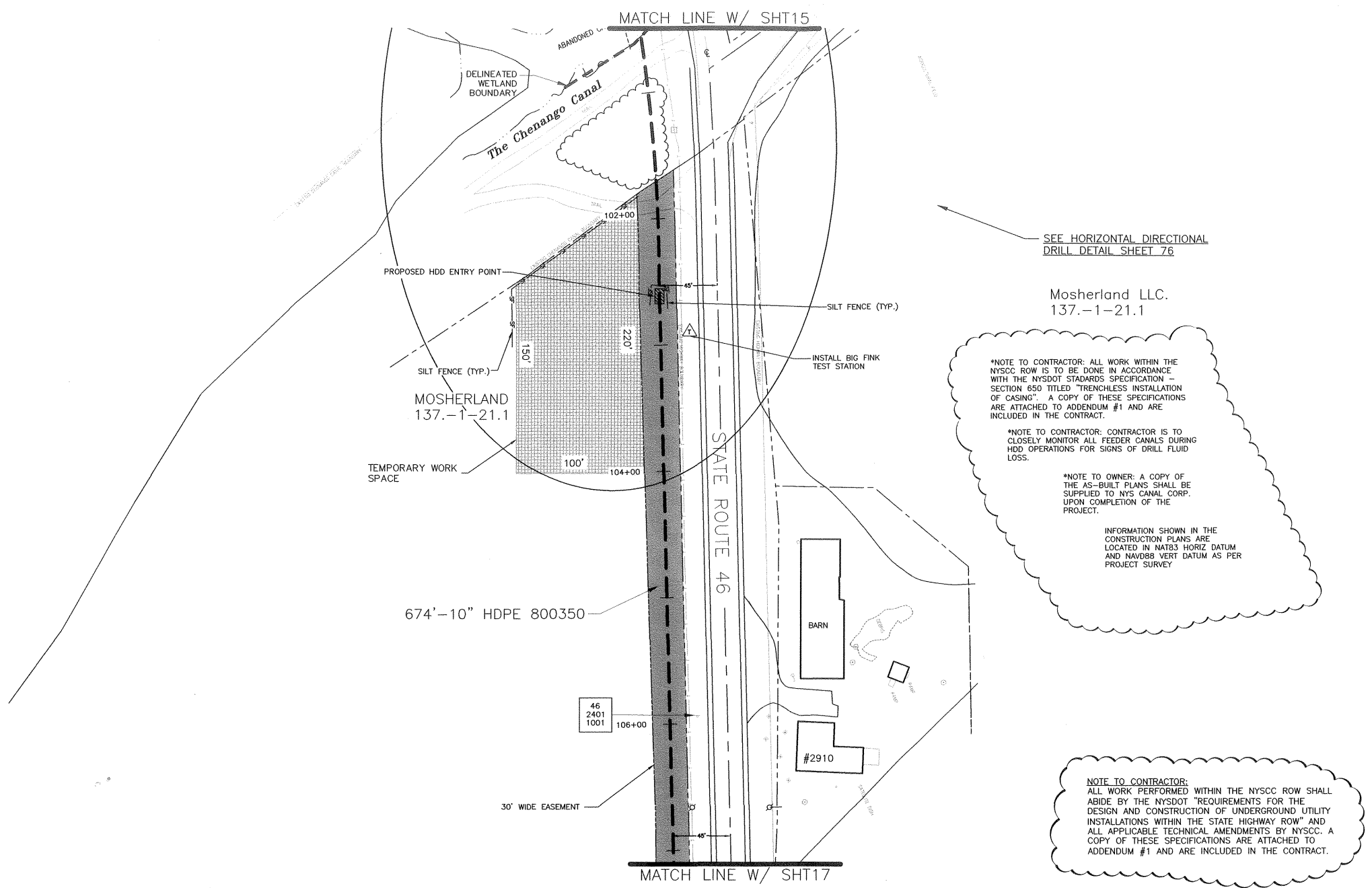

SEE HORIZONTAL DIRECTIONAL
DRILL DETAIL SHEET 76

Mosherland LLC.
137.-1-21.1

*NOTE TO CONTRACTOR: ALL WORK WITHIN THE
NYSCC ROW IS TO BE DONE IN ACCORDANCE
WITH THE NYS DOT STANDARD SPECIFICATION -
SECTION 650 TITLED "TRENCHLESS INSTALLATION
OF CASING". A COPY OF THESE SPECIFICATIONS
ARE ATTACHED TO ADDENDUM #1 AND ARE
INCLUDED IN THE CONTRACT.

*NOTE TO CONTRACTOR: CONTRACTOR IS TO
CLOSELY MONITOR ALL FEEDER CANALS DURING
HDD OPERATIONS FOR SIGNS OF DRILL FLUID
LOSS.

*NOTE TO OWNER: A COPY OF
THE AS-BUILT PLANS SHALL BE
SUPPLIED TO NYS CANAL CORP.
UPON COMPLETION OF THE
PROJECT.

INFORMATION SHOWN IN THE
CONSTRUCTION PLANS ARE
LOCATED IN NAT83 HORIZ DATUM
AND NAVD88 VERT DATUM AS PER
PROJECT SURVEY

NOTE TO CONTRACTOR:
ALL WORK PERFORMED WITHIN THE NYSCC ROW SHALL
ABIDE BY THE NYS DOT "REQUIREMENTS FOR THE
DESIGN AND CONSTRUCTION OF UNDERGROUND UTILITY
INSTALLATIONS WITHIN THE STATE HIGHWAY ROW" AND
ALL APPLICABLE TECHNICAL AMENDMENTS BY NYSCC. A
COPY OF THESE SPECIFICATIONS ARE ATTACHED TO
ADDENDUM #1 AND ARE INCLUDED IN THE CONTRACT.

ADDENDUM #1

NOTE TO OWNER: THIS MAP WAS CREATED FROM PREVIOUS CONSTRUCTION PLANS PREPARED BY INTERGRITY ENGINEERING FOR THE HAMILTON PIPELINE PROJECT. DDS COMPANIES IS NOT RESPONSIBLE FOR THE INFORMATION INCLUDED IN THESE DRAWINGS OTHER THAN THE REVISIONS ADDRESSING THE AGENCY COMMENTS FOR FINAL PERMITTING. NO FIELD VERIFICATION HAS BEEN DONE TO VERIFY EXISTING FEATURES, ELEVATIONS OR PLAN LOCATIONS REPRESENTED ON THESE PLANS AS PREPARED AND DESIGNED BY THE OWNERS ENGINEER OF RECORD FOR THE CREATION OF THE PROJECT CONTRACT DOCUMENTS.

NOTE TO CONTRACTOR: THIS MAP WAS CREATED FROM AVAILABLE RECORD MAPS, TAX MAPS, AERIAL OVERLAYS, AND WHERE POSSIBLE A FIELD EDIT WAS PERFORMED. NO ACTUAL FIELD SURVEY WAS PERFORMED AND THEREFORE DDS COMPANIES CANNOT ASSURE ITS ACCURACY. EXISTING UTILITY LOCATIONS AND TOPOGRAPHIC INFORMATION ARE APPROXIMATE AND SHALL BE VERIFIED IN THE FIELD BY THE CONTRACTOR PRIOR TO COMMENCING CONSTRUCTION OR APPLYING IT FOR ANY PURPOSE.

HAMILTON PIPELINE
Village of Hamilton
County of Madison
State of New York

REV #	Description	Date	By

DESIGN	APPROVAL	DATE

PROJECT NO:
HAM 22-14-H001

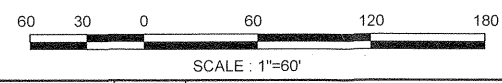

DDS
45 HENDRIX ROAD
W. HENRIETTA, NY 14586
PHONE (585) 359-7540
FAX (585) 359-7547

DATE: MARCH 2014
DESIGNED BY: C. KARELUS
CHECKED BY:
APPROVED BY:
AS-BUILT DATE:

SHEET NO.
SH16

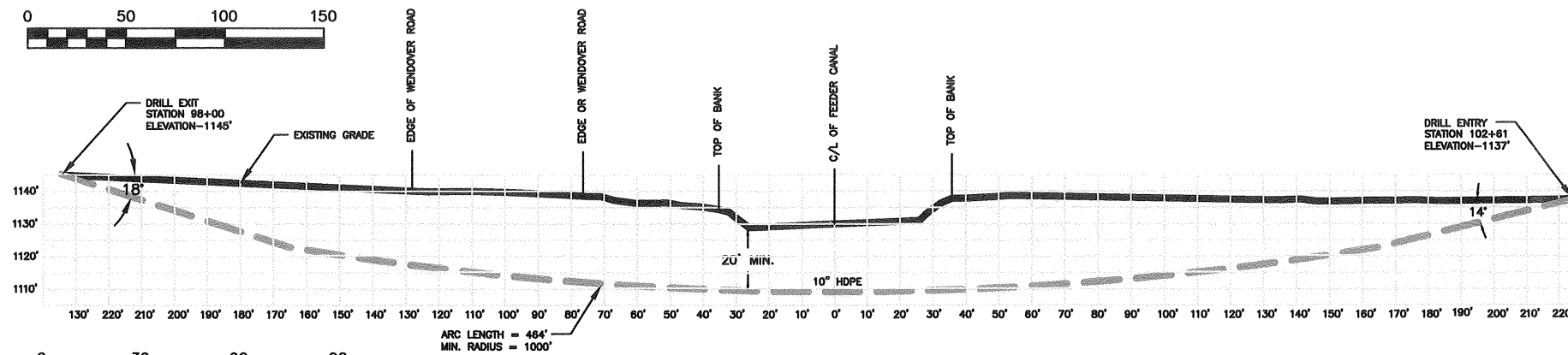
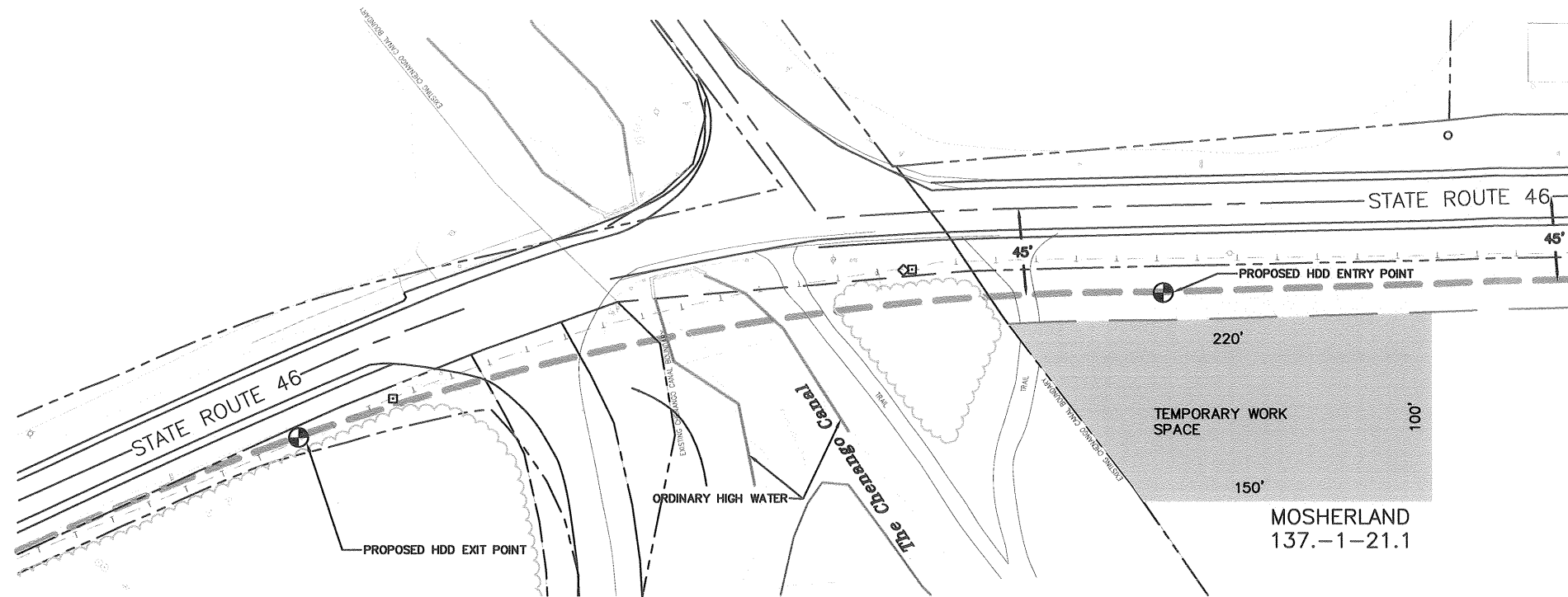

HORIZONTAL DIRECTIONAL DRILL-WENDOVER ROAD
REFERENCE SHEET 15 AND 16



UNAUTHORIZED ALTERATION
OR ADDITION TO PLANS
BEARING A LICENSED
ENGINEER'S SEAL IS A
VIOLATION OF SECTION 7209
OF THE NEW YORK STATE
EDUCATION LAW

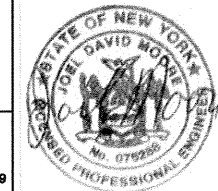

INTEGRITY
ENGINEERING PLLC

www.gasengineering.com

HAMILTON PIPELINE

SIZE	FSCM NO.	WORK ORDER NO.	REV
C		13-001-02	-
SCALE	NONE	DATE	11-09-13
		SHEET	76 OF 86